

LOCKIT

Parts List, Installation and General Information

MDLI

Parts List

Please make sure you have received all the following parts

- (1) Lock mechanism.
- (2) Back plate, with 'hold open' snib mechanism.
- (3) 2 x Neoprene seals (placed between lock mechanism and door and back plate and door).
- (4) Spindles - one for 60mm thick doors, one for 70mm doors.
- (5) Latch - 60mm standard.
- (6) Strike plate.
- (7) 4 x wood screws to secure latch and strike plate.
- (8) Latch support post.
- (9) Tweezers - see note on changing access code.
- (10) 3 x fixing screws. These may need cutting to length (see note). Only two are actually required - one spare is provided.
- (11) 2 x spare tumblers. These allow number of digits in access code to be changed - see note below.
- (12) Card advising lock's existing factory-set code. See note below re code changing.
- (13) Plastic clip. This is used if the snib mechanism is removed - see note below.

Please check...

- (1) If you have ordered a Hold Open lockset, it should have a snib on the backplate. This allows the latchbolt to be held back when required.
- (2) Check that all mechanisms function correctly before starting to install. Enter the code shown on the card enclosed with the lock; the knob should turn freely under hand pressure and return automatically via its internal spring. The lever handle on the backplate should also move freely; if a snib is fitted, it should retain in the required position. The latch bolt should be easily depressed, either under finger pressure or by inserting and turning a spindle in the latch cam.

If you wish to change the factory-set access code, we suggest you do this before fitting the lock. Instructions are included below.

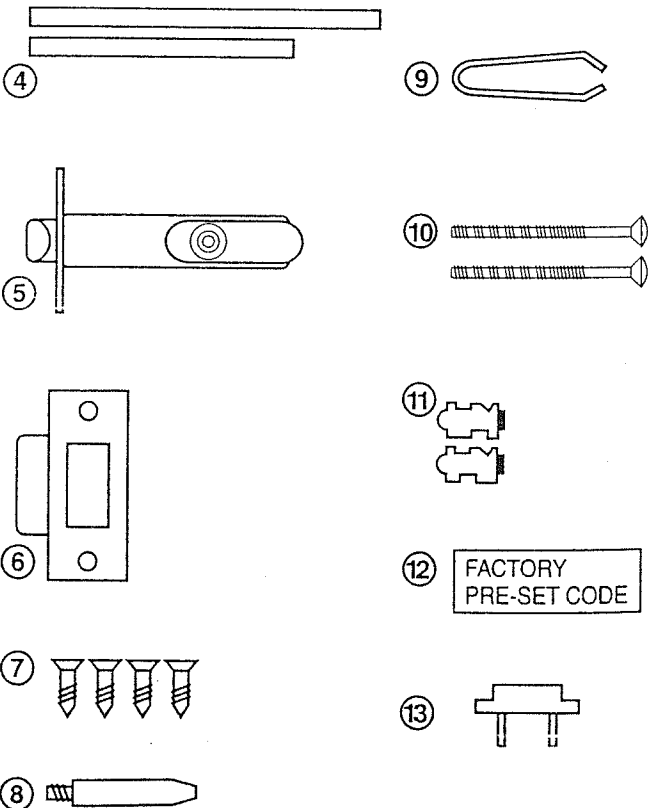
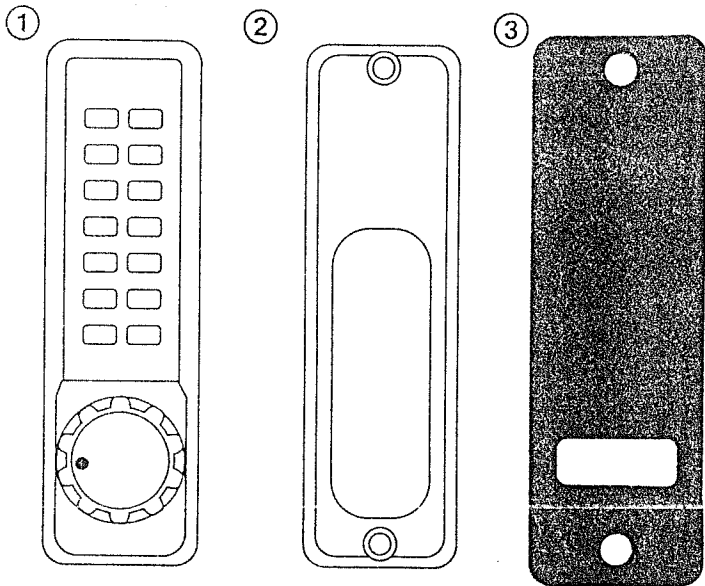

Installation

(1) Establish the 'hand' of the door

Use the diagram, and note that 'right' or 'left' refers to the position of the hinges from the OUTSIDE, regardless of whether the door swings inwards or outwards. Factors affected by handing arise later in these instructions.

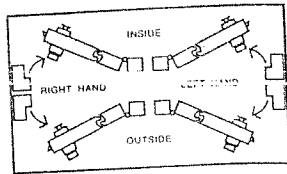

(2) Position the templates

You may wish to begin by marking the centre line of the latch on the edge of the door. This line can then be used to position the 'inside' and 'outside' templates accurately in relation to one another. Note that separate edges are shown for 60mm and 70mm thick doors.

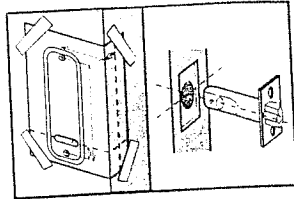

(3) Drill the holes indicated.

Note that four of the holes need clearing with a chisel to produce a slot.

(4) Fit the latch

Drill a 25mm dia hole 85mm deep into the edge of the door (on the line already marked) to receive the latch. Insert the latch and draw round the face plate; this is then used to guide cutting of a 3mm rebate. When the rebate is cut, the latch may then be permanently fitted into position.

(5) Latch support post.

Fit this to the back of the lock case - into hole 'A' for a right-hung door (see Note 1) or hole 'B' for a left-hung door.

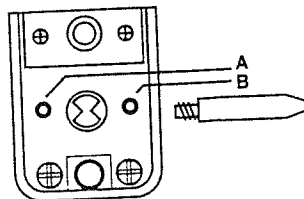

(6) Hold-open versions.

If you are fitting a hold-open version of the lock to a left-handed door, the blue screw must be located in the right-hand hole 'B'.

(7) Spindle position.

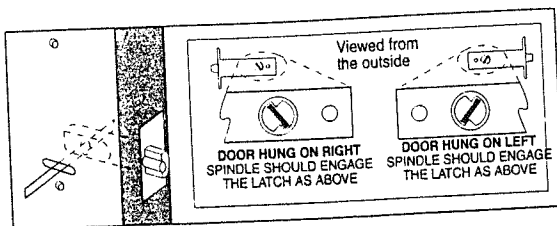

Check from outside that the slot in the latch is correctly positioned for the door concerned. Then select the spindle that suits the thickness of the door, and insert it through the latch.

(8) Assembling lock onto door

If necessary, cut the fixing bolts to suit the thickness of the door. If they have to be cut, at least one full turn of thread should engage the lock body, through backplate, door and both seals, without overtightening.

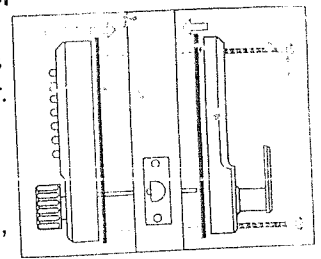

Assemble lock and backplate onto door, using the Neoprene seals. Before final tightening, make sure all functions work freely and satisfactorily (and check the function of the code before closing the door!). Do not overtighten the bolts, as this may lead to poor performance.

(9) Strike Plate.

The strike plate should be positioned so that it allows only the FLAT SECTION of the latchbolt to enter, and NOT the plunger. When the door is locked, the plunger must remain pressed against the surface of the strike plate if it is to retain its anti-tamper function.

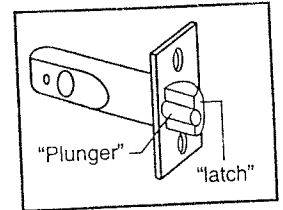

When the correct position has been established, mark round its edges and use marks as a guide for cutting a 1mm rebate. The plate should be flush with the frame. Then drill or cut a recess to receive the bolt.

Now fit the plate with just one screw. Test the lock for satisfactory function, and make any slight adjustments necessary; the plate may then be finally fitted.

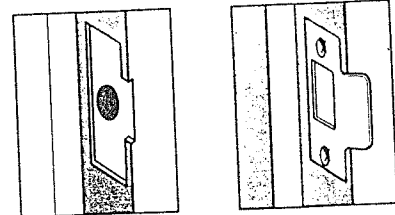

General Information

Removing Snib Function

The snib function may be removed by removing the backplate (taking care not to dislodge small parts - do this on a firm, flat surface) and removing the four screws holding the snib mechanism. This will allow the metal plate to be removed, along with the snib itself and a spring and a ball bearing.

The plate can then be replaced, using the plastic clip provided to close the aperture left by removing the parts concerned.

Changing the access code

Your lock has been pre-programmed with a five-digit access code. This section tells you how this code may be changed.

You will also have been supplied with spare tumblers; these may be used to reduce the code to four digits or to increase it to six or seven digits.

Also supplied is a pair of tweezers for removing the tumblers. Make sure these are ready to hand.

(1) Remove the main body of the lock from the door.

(2) Place the lock body face down on a firm, flat surface, and remove the four screws securing the back plate. Take care at this stage, as there are many small parts that might become loose.

(3) Removing the back plate will reveal lock tumblers in two columns of seven - 5 red, 8 blue and one clear. Red tumblers relate to the code; blue tumblers are 'nul'. The clear tumbler is activated by the 'C' button, AND SHOULD NEVER BE REMOVED.

(4) Tumblers are freed by pressing the 'C' button, when they may be withdrawn using the tweezers provided. Transposing red and blue tumblers in the lock will change the existing five-digit code; exchanging red and blue tumblers from the 'spares' provided will alter the number of digits used in the code.

PLEASE NOTE that tumblers must be correctly positioned, according to the 'column' in which they are placed. (See drawing below).

(5) When you have completed your changes, make a note of the new code!

(6) Reassemble back plate - satisfy yourself that the new code operates as expected.

(7) Re-fit lock to door. Once again, test the new code before closing the door.

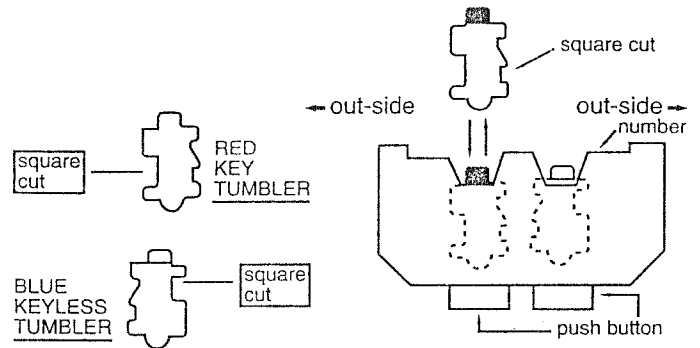

TEMPLATES

