



# Instant Road Repair

## Cold Lay Asphalt Concrete

### Applications

Ultracrete Instant Road Repair is a BBA/HAPAS Approved Permanent Cold Lay Surfacing Asphalt Concrete for first time permanent reinstatements and pothole repairs in footways, footpaths, cycle tracks and type 3 and 4 roads. The product offers the benefits of an instant, first time permanent reinstatement, which when compacted, can be trafficked immediately. It is also suitable as a high quality temporary repair to potholes and reinstatement areas.

### Technical

Ultracrete Instant Road Repair is supplied in 25kg bags and/or plastic containers and includes fully graded, high PSV interlocking aggregate as well as specially formulated bitumen, containing polymers and flexibilisers. The product is available in 6 and 10mm surface course grades in black, and red in 6mm only. Ultracrete Instant Road Repair also forms part of the Ultracrete BBA/HAPAS Approved Ironwork Reinstatement System. For a copy of the certificates please call Instarmac Sales on: +44 (0) 1827 872244 or visit our website on [www.instarmac.co.uk](http://www.instarmac.co.uk)

### Preparation

Saw cut a 'picture frame' around the repair or reinstatement area. Ensure the area is clear of debris. Compact the sub-base to the specified depth below the existing surface course.

### Application 6mm

Reinstatements requiring up to 60mm in depth can be achieved by using the layer-on-layer method.

1. Apply the product to a depth of approximately 45mm and compact to 30mm in order to achieve your first layer.
2. Repeat the same process to achieve the 60mm depth.

Note: All compaction should be carried out in accordance with Appendix 8 of the SROH\* 2002.

If overbanding is required, apply Ultracrete Instaband. Re-apply Ultracrete SCJ Edge Sealant to vertical edges before the application of a new layer of Instant Road Repair.

### Application 10mm

Reinstatements requiring up to 100mm in depth can be achieved by using the layer-on-layer method.

1. Apply the product to a depth of approximately 45mm and compact to 30mm in order to achieve your first layer.
2. Repeat the process to achieve the second layer.
3. Finally, apply a 60mm layer and compact to 40mm to provide the final surface course. Note: All compaction should be carried out in accordance with Appendix 8 of the SROH\* 2002.

If overbanding is required, apply Ultracrete Instaband. Re-apply Ultracrete SCJ Edge Sealant to vertical edges before the application of a new layer of Instant Road Repair.

### Health & Safety

The binder used in Ultracrete Instant Road Repair is particularly tenacious. Ensure that protective gloves, overalls and protective footwear are worn at all times while handling the material. Avoid skin contact. However, should the bitumen binder adhere to the skin it can be removed with soap and water. seek medical advice if discomfort continues. If product comes into contact with the eyes rinse with plenty of water and seek medical advice. For a full updated Material Safety Data Sheet please visit [www.instarmac.co.uk](http://www.instarmac.co.uk)



### Features & Benefits

- Part of the Ultracrete BBA/HAPAS Approved Ironwork Reinstatement System
- 6mm and 10mm grades are BBA/HAPAS approved for first time permanent repairs in footways, cycle tracks and class 3 & 4 carriageways
- Reduces congestion and fuel costs
- Can be used in hot, freezing & wet weather conditions
- Rapid repair time – no cooling required
- Supports the requirements of the Traffic Management Act – open to traffic instantly
- Cost and labour effective – only one visit required
- Eliminates the need for disposal of temporary materials to landfill sites
- Reduces the health and safety risks of working with a hot material
- Environmentally friendly
- High PSV (skid resistance) provides a safer trafficking surface
- Guarantees high performance temporary and emergency repairs on motorways and trunk routes



New Packaging from Nov 2010!

### Related Products

- Ultracrete Permanent Pothole Repair** Cold Lay Asphalt Concrete for the repair of potholes
- Ultracrete Envirobed HA104®** High Performance Bedding Mortar
- Ultracrete PY4** Polyester Resin Fast Setting Bedding Mortar
- Ultracrete M60** Rapid Strength Bedding Mortar
- Ultracrete QC10** Fast Set Rapid Strength Concrete
- Ultracrete SCJ** Spray Applied Bitumen Cold Joint Sealer

\*Specification for the Reinstatement of Openings in Highways.



# Instant Road Repair

Cold Lay Asphalt Concrete

## Physical Properties

|                     | BBA/HAPAS Approved         | PSV | Colour           | Unit/ Packaging                        |
|---------------------|----------------------------|-----|------------------|--|
| 10mm Wearing Course | Class 3 & 4 Carriageways   | 65  | Black            | 25kg Plastic Bag or Plastic Containers |
| 6mm Wearing Course  | Footpaths and Cycle Tracks | 65  | Black & Dark Red | 25kg Plastic Bag or Plastic Containers |

## Instructions for First Time Permanent Repairs

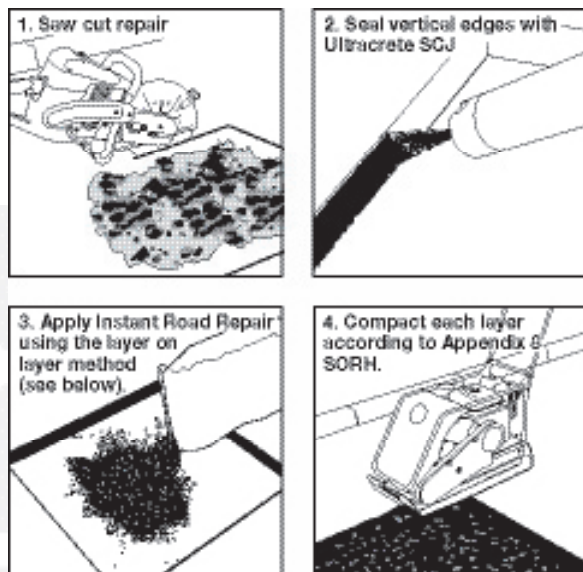

## Product Details

|                     |  |
|---------------------|--|
| Storage             | Store in a cool and well-ventilated place  |
| Shelf Life          | Shelf life in correct conditions for sealed goods is:<br><b>Bag:</b> Up to 3 months – Delivered on shrink-wrapped pallets.<br><b>Tub:</b> 6 months – Delivered on shrink-wrapped pallets   |
| Coverage            | Approximately 1m <sup>2</sup> x 15mm compacted   |
| Handling Guidelines | Ultracrete Instant Road Repair is manufactured and delivered within as short a time as possible to ensure fresh easy to lay material is supplied. It should be noted that bags on pallets, particularly those at the bottom, could appear firm. Applying light pressure to the edge of the bag will restore the material to its normal consistency |

## Instructions for Pothole Repairs

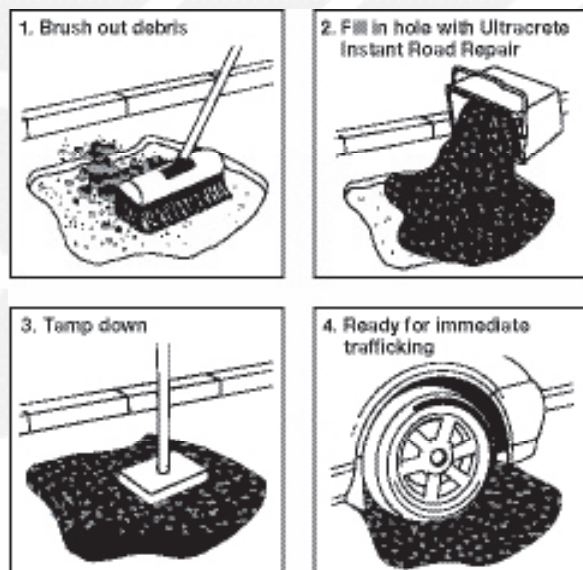

## Contact Us

**Instarmac® Group plc**, Birch Coppice Business Park, Danny Morson Way, Dordon, Tamworth, Staffordshire, B78 1SE, United Kingdom

Tel: +44 (0) 1827 872244 Fax: +44 (0) 1827 874466

Email: [email@instarmac.co.uk](mailto:email@instarmac.co.uk) Order: [orders@instarmac.co.uk](mailto:orders@instarmac.co.uk) Website: [www.instarmac.co.uk](http://www.instarmac.co.uk)

Ultracrete products are guaranteed against defective materials and manufacture, and will be replaced or money refunded if the goods do not comply with our promotional literature. We cannot however accept any liability arising from the application or use of our products because we have no direct or continuous control over where and how our products are used. All products are sold subject to our conditions of sale, copies of which may be obtained on request.